

George Fischer Diaphragm Valve Type 314



Diaphragm valves are especially suitable for flow control applications. Also suitable for slurries and abrasive media.

- “Snap-on” handwheel - easy to remove
- Option: lockable handle
- Position indicator, improved robustness
- Can also be used in vacuum applications

General

Manual, weir type diaphragm valve Type 314 with union ends in sizes 1/2" – 2" (20 mm – 63 mm) in PVC, Polypropylene (PP), SYGEF-PVDF and SYGEF-PVDF HP.

Can be connected into the pipeline without additional fittings.

Short overall length.

Flow in either direction irrespective of installation position.

Easy replacement of the diaphragm without removal of the body from the pipeline.

Bracketing facility incorporated in the valve.

Also available pneumatically actuated, see +GF+ DIASTAR information.

Technical Features

- a) True union ends with sockets
 - Polypropylene, SYGEF-PVDF: plain spigots for socket fusion joining (mm sizes)
 - Polypropylene and SYGEF IR: butt fusion ends for butt fusion joining (mm sizes)
 - SYGEF BCF ends for Bead and Crevice free joining
- b) Union nuts allow easy valve installation and removal
- c) EPDM O-ring with EPDM diaphragm or FPM O-ring with PTFE diaphragm
- d) EPDM or PTFE diaphragm with compression rib
- e) PP GF 30 (glass-fiber reinforced polypropylene) bonnet
- f) Polypropylene handwheel
- g) PE handwheel seal
- h) PE position indicator
- i) Stainless steel (304) assembly bolts
- k) Stainless steel threaded bushing facilitates bracketing of the valve. Do not overtighten bolts.

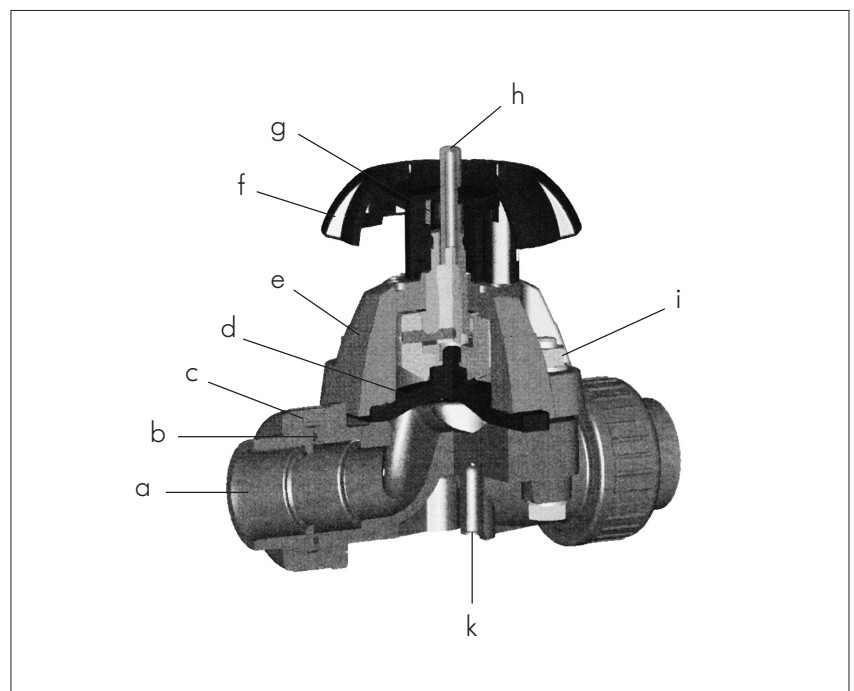

Dimensions for Type 314 True Union Diaphragm Valve PVC (solvent cement socket ends)

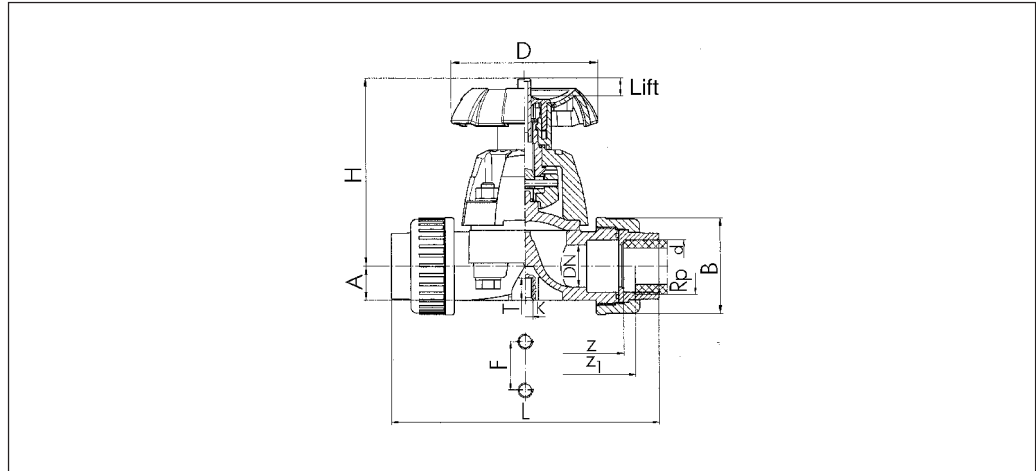

Inch size	A inch	B inch	D inch	F inch	K mm	H inch	L inch	T inch	Z inch	Lift inch	Weight lbs.
1/2	0.55	1.69	3.15	0.98	M6	3.54	5.35	.47	3.78	0.32	0.88
3/4	0.69	2.09	3.15	0.98	M6	4.02	6.30	.47	4.49	0.43	1.32
1	0.83	2.36	3.70	0.98	M6	4.67	6.93	.47	4.80	0.51	1.98
1-1/4	1.00	2.91	4.61	1.77	M8	4.96	7.80	.59	5.51	0.63	2.65
1-1/2	1.28	3.27	4.61	1.77	M8	5.47	9.13	.59	6.30	0.83	3.53
2	1.54	4.06	5.98	1.77	M8	6.77	10.55	.59	7.48	1.10	6.17

Part Numbers - PVC



Inch size	solvent cement socket (ASTM) Diaphragm Material:	
	EPDM	PTFE (Teflon®)
1/2	161 314 677	161 314 692
3/4	161 314 678	161 314 693
1	161 314 679	161 314 694
1-1/4	161 314 680	161 314 695
1-1/2	161 314 681	161 314 696
2	161 314 682	161 314 697

Silicon free - PVC

Part number

Inch size	solvent cement socket (ASTM) Diaphragm Material:	
	EP	PTFE (Teflon®)
1/2	161 314 777	161 314 792
3/4	161 314 778	161 314 793
1	161 314 779	161 314 794
1-1/4	161 314 780	161 314 795
1-1/2	161 314 781	161 314 796
2	161 314 782	161 314 797

Other diaphragm materials available on request.

Handwheel with built-in locking mechanism



Teflon® is a registered trademark of DuPont.

Inch Size	Part Number
1/2	167 481 943
3/4	167 481 943
1	167 481 944
1-1/4	167 481 945
1-1/2	167 481 945
2	167 481 946
2-1/2	167 481 946

Dimensions for Type 314 True Union Diaphragm Valve Polypropylene and SYGEF-PVDF (IR-Butt, socket and BCF fusion ends)

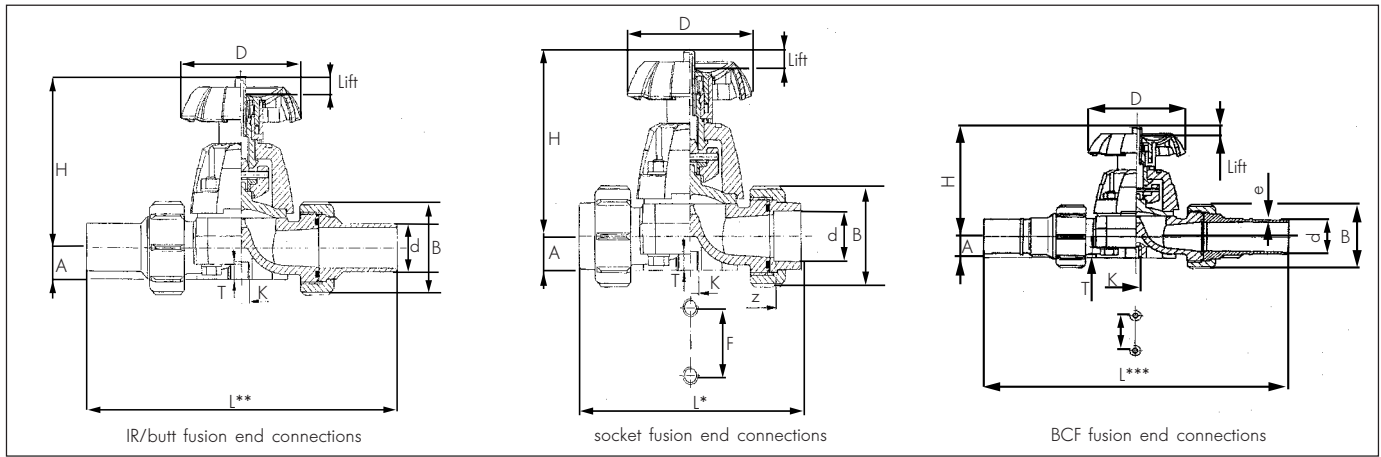

Metric size d mm	e mm	A inch	B inch	D inch	F inch	H inch	K mm	L* inch	L** PP inch	L** PVDF inch	L*** PVDF inch	T PP inch	T PVDF inch	z inch	Lift inch
20	1.9	0.55	1.77	3.15	0.98	3.54	M6	5.04	7.72	7.72	8.86	0.47	0.49	3.94	0.31
25	1.9	0.69	2.17	3.15	0.98	3.98	M6	5.91	8.70	8.66	9.53	0.47	0.49	4.65	0.43
32	2.4	0.85	2.44	3.70	0.98	4.61	M6	6.38	9.21	9.21	10.00	0.47	0.49	4.96	0.51
40	2.4	1.00	2.95	4.61	1.77	5.00	M6	7.24	10.24	10.16	12.13	0.59	0.49	5.67	0.63
50	3.0	1.26	3.29	4.61	1.77	5.47	M6	8.27	11.18	11.18	12.99	0.59	0.49	6.46	0.83
63	3.0	1.54	3.98	5.98	1.77	6.77	M6	9.76	12.64	12.60	14.69	0.59	0.49	7.64	1.10

Metric size d mm	Weight* PP lbs.	Weight** PP lbs.	Weight* PVDF lbs.	Weight** PVDF lbs.	Weight*** PVDF lbs.
20	0.904	0.93	1.04	1.08	1.10
25	1.279	1.32	1.52	1.57	1.61
32	1.742	1.79	2.07	2.14	2.20
40	2.734	2.80	3.31	3.42	3.53
50	3.527	3.64	4.32	4.50	4.61
63	6.261	6.48	7.52	7.80	7.98

* socket fusion
 ** IR/butt fusion
 *** BCF fusion